

ecolux®
X-Wall

Monteringsanvisning

Måttskiss

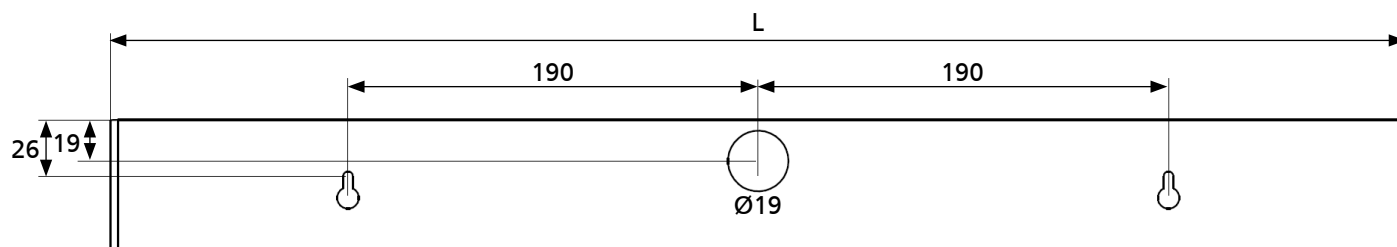

Armatur	L (mm)
X-Wall	574
X-Wall NS1	600

Monteringsdetaljer (för IP44)

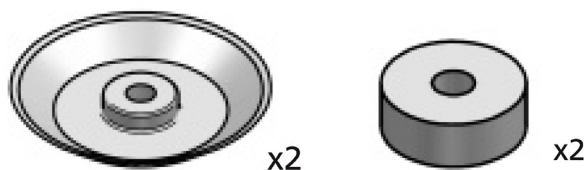

Installation

1. Demontera kupan



2. Demontera LED-modulen

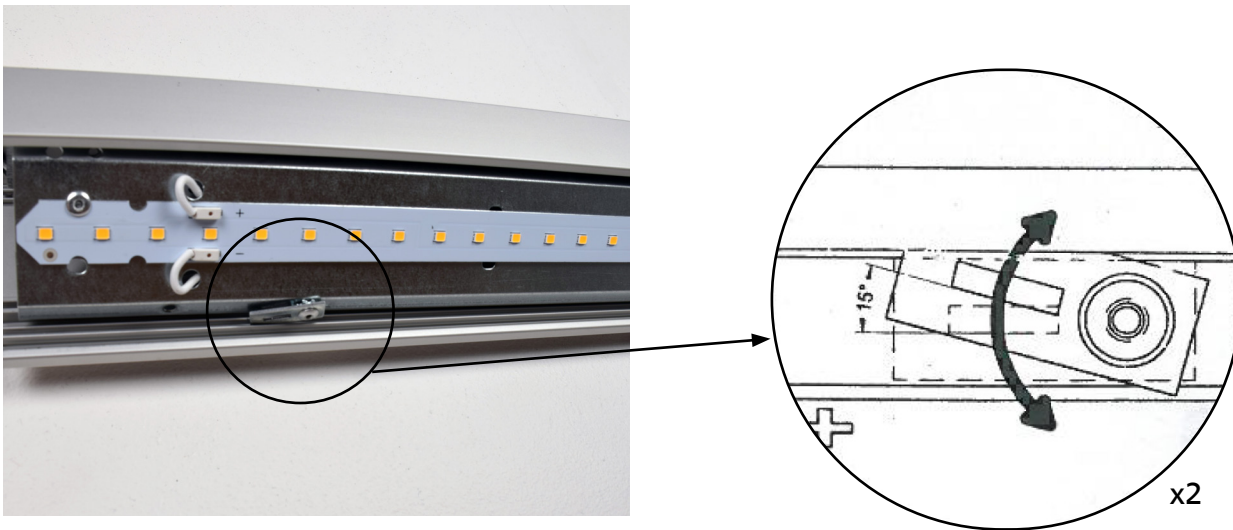

3. Montera armaturhuset med tillhörande monteringsdetaljer och anslut därefter kabeln.

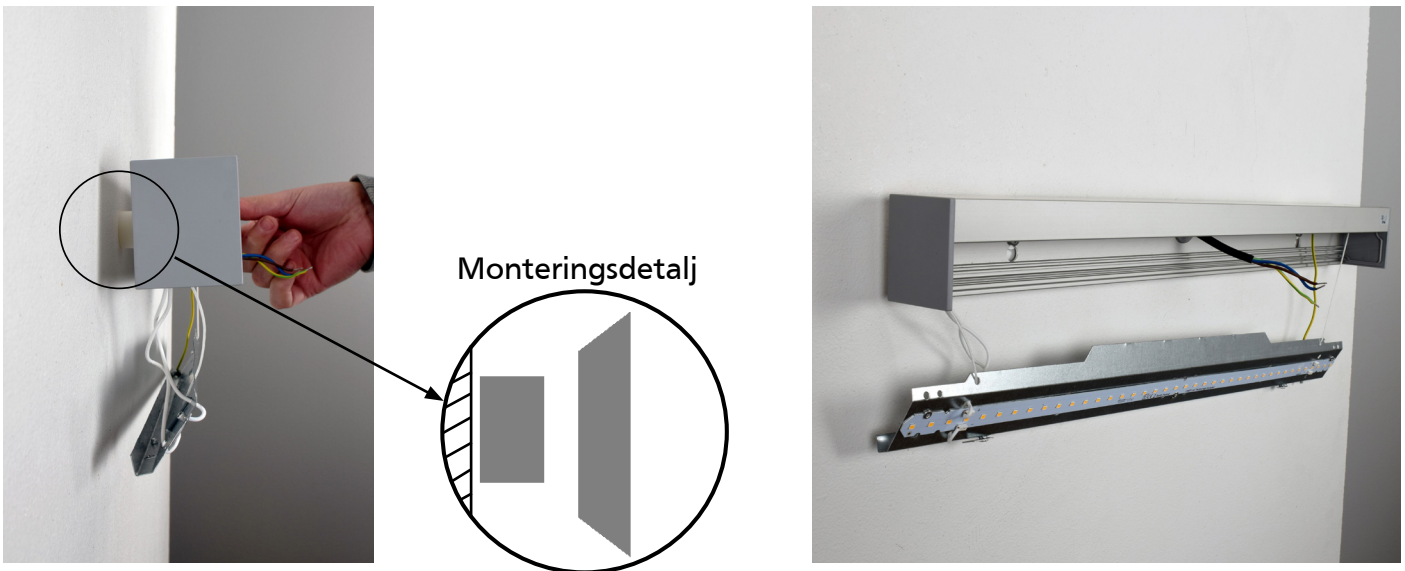

X-Wall

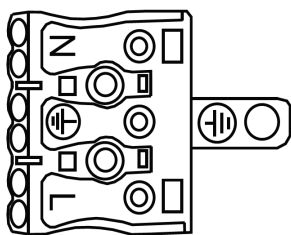

X-Wall NS1

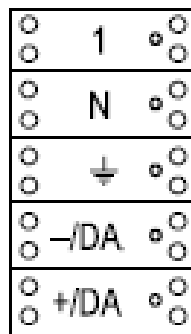

Slav*

*230V utgång för sensorn för vidarekoppling, max 100W.

4. Montera fast LED-modulen i det inre spåret.

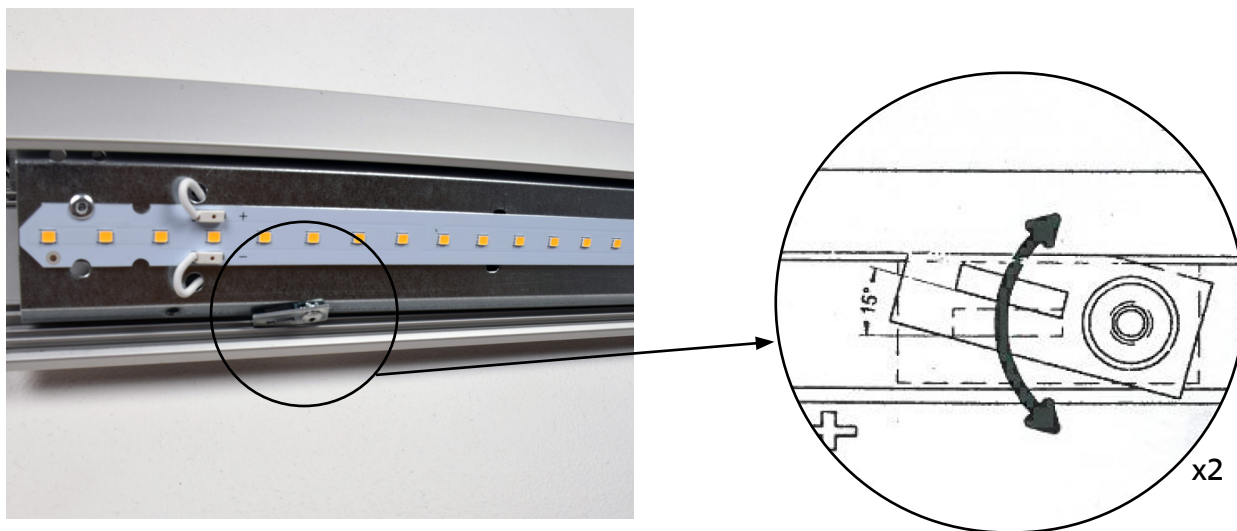

5. Montera kupan.

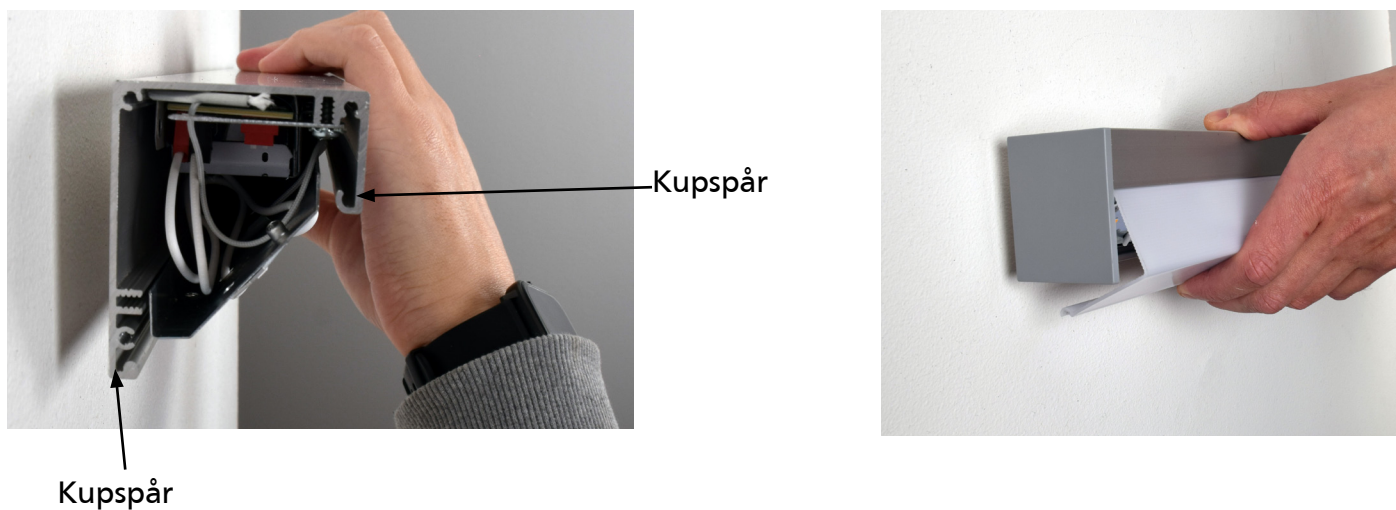

Underhåll

Vid behov avtorkas armaturen med antistatisk duk

ecolux[®]
when light matters

Ecolux AB | Box 73 | 265 21 ÅSTORP | Tel: 010-130 11 00 | E-post: info@ecolux.se
Vi reserverar oss för eventuella tryckfel.